

A1

DO NOT SCALE

File: CP1770-BLP-ZZ-ZZ-M2-MA-0001-00 Overall Site Location Map.dwg
Date: Jul 05, 2019 - 4:30pm Plotted by: TJOConnell

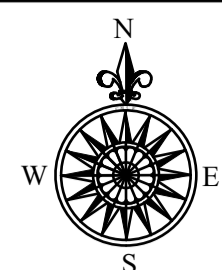

- GENERAL NOTES**
1. ALL DIMENSIONS ARE IN MILLIMETRES UNLESS NOTED OTHERWISE.
 2. ONLY WRITTEN DIMENSIONS SHALL BE USED. NO DIMENSIONS SHALL BE SCALED FROM THE DRAWINGS.
 3. ALL LEVELS ARE IN METRES AND ARE TO ORDNANCE DATUM MALIN UNLESS NOTED OTHERWISE.
 4. ALL COORDINATES ARE IN METRES AND ARE TO IRISH TRANSVERSE MERCATOR.
 5. DRAWINGS ARE TO BE READ IN CONJUNCTION WITH THE SPECIFICATION.
 6. ALL DRAWINGS ARE THE PROPERTY OF ATKINS BYRNELOOBY.
 7. [xx.xx m CD] REFER TO LEVELS AT CHART DATUM (DUBLIN PORT).
 8. ORDNANCE DATUM MALIN [O.D.M.].
 CHART DATUM [C.D.] (DUBLIN PORT)
 2.51m
 9. OS MAP SHEET NO:
 3198-18, 3198-19, 3198-20, 3198-23, 3198-24, 3198-25, 3199-16, 3199-17, 3199-18, 3199-21, 3199-23, 3199-24, 3264-2, 3264-3, 3264-4, 3264-5, 3264-8, 3264-9, 3264-10, 3264-13, 3264-14, 3264-15, 3265-1, 3265-6, 3265-7, 3265-8, 3265-9, 3265-11, 3265-12.

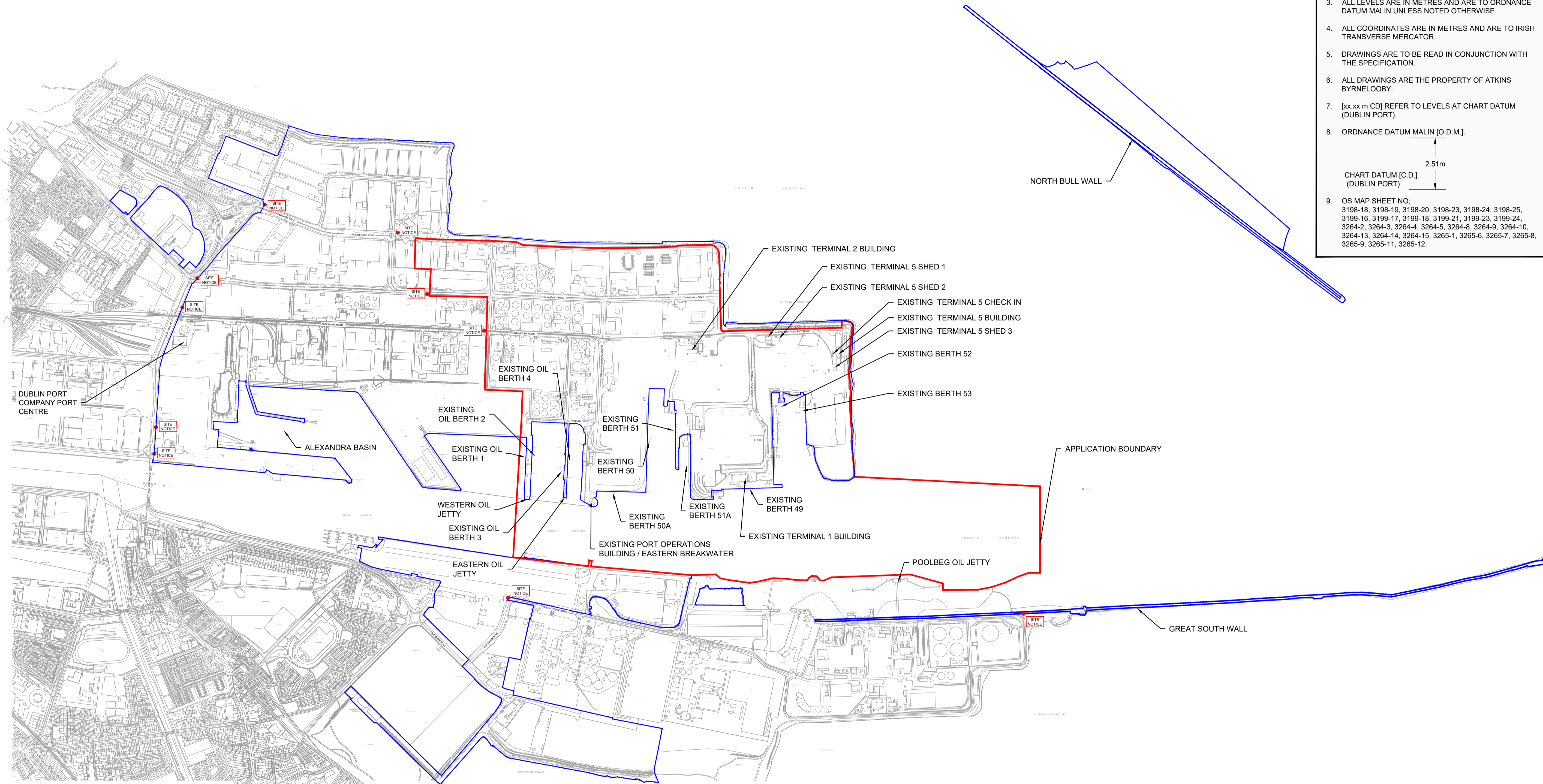

Ordnance Survey Ireland Licence No. EN 0061919
© Ordnance Survey Ireland/Government of Ireland

- APPLICATION BOUNDARY
- SITE NOTICE
- DUBLIN PORT ESTATE BOUNDARY

Rev	Description	By	Date	Chk'd	Auth
00	ISSUED FOR PLANNING	TJO	07.19	SMC	AC

ATKINS
Member of the SNC-Lavalin Group

BYRNELOOBY
WS Atkins Ireland Ltd. & ByrneLooby Partners Ltd.
Atkins House,
150 Airstide Business Park,
Swords, Co. Dublin

Client
**COMHLACHT CHALAFOR
ÁTHA CLIATH
DUBLIN PORT COMPANY**

Project
MP2

Purpose PLANNING					
Title OVERALL SITE LOCATION MAP					
Original Scale 1:7,500 @A1	Design/Drawn TJOC	Checked SMC	Authorized AC		
Date 28.09.18	Date 28.09.18	Date 28.09.18	Date 28.09.18		
Status P	Drawing Number CP1770-BLP-ZZ-ZZ-M2-MA-0001	Rev 00			